

## **SUPERINTENDENT / CHAIR OF CI DISTRICT**

The Rev'd Dawn Saunders / Tel: 722093 / E: [revdawnsaunders@gmail.com](mailto:revdawnsaunders@gmail.com)

### **ADMINISTRATOR:**

Donna-Marie Rault  
E: [circuit.office.jsy@gmail.com](mailto:circuit.office.jsy@gmail.com)

### **CONNECT:**

[www.jerseymethodist.org.uk](http://www.jerseymethodist.org.uk)  
Facebook 'Jersey Methodist Circuit'

# Prayer for the Week: February

## *Week commencing 1<sup>st</sup> February*

Creator God, thank you for the changing of the seasons and for the lighter mornings and evenings, which make us feel so much better. May we take time to be present with you and see your glory reflected in the beautiful flowers and trees and fields and in every person we meet. Amen.



## *Week commencing 8<sup>th</sup> February*

Loving and living Lord, may each day of our lives be lived as a pleasing prayer to you. Help us to hold you at the centre of our lives and always be true to your values. Amen.



## *Week commencing 16<sup>th</sup> February*

Father God,  
As we look forward to Lent, help us to think of something to give up or something to start, which will give us a greater focus on our journey with you. May we be enriched through these 40 days of Lent. Amen.



## *Week commencing 22<sup>nd</sup> February*

As we look forward to Spring and warmer weather, breathe new life into us and help us to share your amazing love with others. In Jesus' name, we pray. Amen.

# *Festival of Light & Water at Ebenezer*

Rev Keith led his annual 'Festival of Light and Water', which included some carols at Ebenezer, on Sunday 4th January.

The service involved keeping the Advent Ring and lighting all the candles at the start of service. During Communion one youngster held baskets of tea lights, which, each congregation member lit from the Advent ring candles. The tea lights were placed in one of the 2 'fonts', with each member giving private prayers for loved ones and the year ahead.

At the end of the service, the 'Christ Candle' was taken out of the Advent Ring and placed on the Communion Table next to the brass Cross, reflecting the light out into the congregation. The 'Christ Candle' will be lit on Sundays as a reminder to us all to carry the light of Christ out into our families and the community around us. The youngsters were then invited to blow out the 4 red candles.

The youngsters also took part in crafts and made paper lanterns, each writing a message inside and were themed with the service.



# The Learning Network

The learning network provides free opportunities for everyone to expand their knowledge. Some online courses available through Eventbrite include:

Follow the Learning Network on Facebook, through *The Learning Network (Methodist Church)* group.

- What is the next step that your church might take in its pathway to net-zero? Methodist Church Eco Community. Book at: <https://www.eventbrite.co.uk/e/methodist-church-eco-community-network-tickets-1113977198789?aff=oddtcreator>
- Mental Health First Aid - 2-day courses for those supporting adults and young people. There is also a half-day mental health aware course. All of these excellent courses are heavily subsidised by the Methodist Church. Book a place at: <https://www.eventbrite.com/cc/mental-health-first-aid-200349?aff=oddtcreator>
- What does it mean for our Churches to be sensory space aware? - an equipping for equality event. Book at: <https://www.eventbrite.co.uk/e/what-does-it-mean-for-our-churches-to-be-sensory-space-aware-registration-1542467183869?aff=oddtcreator>

## Equipping for Equality

A development session for those in the Methodist Church passionate about Justice, Dignity and Solidarity

What does it mean for our churches to be sensory space aware?

Tuesday 10th February

7pm - 9pm

on Zoom



Reserve your spot at: <https://www.eventbrite.co.uk/e/what-does-it-mean-for-our-churches-to-be-sensory-space-aware-registration-1542467183869?aff=oddtcreator>

# “Life” Scripture Service at Bethesda

Bethesda held a Fellowship Service recently and people were asked to bring along a "Life" scripture - verses that have sustained them in their life's journey; perhaps when times have been tough, or there has been a need for strength or comfort or verses that have sustained them when their faith was weak.

During the service, with tea or coffee, folk wrote out their verses on a piece of card which they then decorated. They also included why these verses meant so much to them. The verses were then displayed on a line and folk were invited to look at them. What is remarkable is the variety of verses chosen - from the Psalms to the Epistles, Old and New Testaments.

The theme of the service was that we are one in Christ with our varying needs in life and how the whole of scripture is vital to our faith journey.. The cards on the line reminded us that we are not alone on our faith journey but part of the community of faith which we recognised by saying the Lord's Prayer, the prayer that Christians all over the world pray together.



# STUART COURT EXTENSION & REFURBISHMENT PROPOSAL



We are pleased to share our proposal to refurbish and extend our care home at Stuart Court.

The plans include a new three-storey extension, increasing the number of bedrooms from 28 to 50, improved accessibility and facilities, enhanced outdoor amenity spaces for residents, and a new main entrance. The design has been carefully developed to respect the existing listed building, while preserving the warm, homely environment that residents value.

We welcome feedback from residents, families, neighbours, and the wider community, and intend to submit a planning application within the next couple of months.

The next three pages detail the proposal. For further information about the project is available at [mhajersey.org](http://mhajersey.org).

*Gerard McCormack*

Chief Executive Officer – MHA

**“Growing, Improving and Preparing for the Years Ahead”**

# STUART COURT EXTENSION & REFURBISHMENT PROPOSAL CONT.

## New Extension

Proposed construction of a three-storey extension designed to complement and enhance the existing, historic listed building. Increase the number of rooms from 28 to 50, helping us meet growing demand for high-quality care and range of care we can provide onsite. Creation of a new car park set below the road and a new main entrance to improve access for residents, visitors and staff. A design focus on ensuring that, although newly built, the extension respects the character and appearance of the existing listed building.

**Pre-Application Feedback**

**1st Quarter 2026**



**Submission of application**  
**2nd Quarter 2026**



**Planning Decision**  
**3rd/4th Quarter 2026**

## Refurbishment of Existing Building

External upgrades, including new windows and external wall insulation. Refurbishment of bedrooms, communal areas, staff rooms, and all laundry rooms. Improved accessibility throughout the building and connection to outside spaces. Installation of a new fire sprinkler system. Enhanced and more accessible outdoor areas. Creation of new spaces accessible outside. Maintaining the warm, homely environment valued by residents.

## A Joint Message from the Chair of the Board and Chief Executive

As a Board and organisation, we have been reflecting on the 60 years since the formation of Methodist Homes for the Aged Jersey and on the care, community, and compassion that have been at the heart of our work for generations. This important milestone has given us an opportunity to look ahead and consider how we can continue to support our residents, both now and into the future.

The proposed extension and refurbishment of Stuart Court are an important part of this journey. The plans aim to modernise the home, provide additional rooms, create more space, and improve accessibility, helping to ensure that Stuart Court remains a comfortable, welcoming, and supportive place to live.

We are very mindful of Stuart Court's history and setting. Great care is being taken to ensure that the design of the extension and all associated works are sensitive to the character of the existing listed buildings and enhance them wherever possible. Preparing the planning application is the first step in this process. Before moving forward with securing funding, we would warmly welcome any thoughts, questions, or feedback you may wish to share.

If you would like to get in touch, you are very welcome to contact us at [CEO@mhajersey.org](mailto:CEO@mhajersey.org) or by phone on **872454**. Further information is also available on our website at [www.mhajersey.org](http://www.mhajersey.org).

With our thanks,

**Anne Pryke** - Chair of the Board

**Gerard McCormack** - Chief Executive



**Gerard McCormack**  
Chief Executive

**Anne Pryke**  
Chair of the Board



# STUART COURT EXTENSION & REFURBISHMENT PROPOSAL CONT.

## Frequently asked questions:

### **What are the timeframes and expectations for the work?**

Should planning permission be obtained, we will as a registered charity, be eligible to apply for funding and seek donations to help address the current funding shortfall before appointing builders. All going well, we expect to have the necessary funding in place for construction to commence in 2028/29.

Planning application to be submitted in the first half of the year expecting to receive a decision towards the end of 2026.

### **Will residents have to move out during the works?**

No. The works will be completed in phases so residents can remain in the home throughout.

- The extension will be built first.
- Once the new rooms are ready, residents will move into them.
- This will allow the existing building to be refurbished while residents are comfortably accommodated.
- After refurbishment, the modernised rooms will be available for new residents.

### **How will you manage noise and disruption?**

We understand the importance of a calm environment. To minimise disruption:

- Contractors will use noise- and dust-reduction measures.
- Work will be scheduled to avoid the home's busiest times of day.
- Modern construction methods and prefabricated sections will be used where possible to shorten the time spent on site.
- By building the extension first, residents can move into brand-new bedrooms before refurbishment begins, reducing disruption inside the existing building.

### **Will residents still be able to use communal areas?**

Yes. Access to communal areas will be maintained wherever possible. If any spaces need to be temporarily closed, suitable alternatives will be provided.

### **How long will the project take?**

The extension and refurbishment will be delivered in carefully managed stages over approximately two years. We will provide regular updates as the project progresses.

### **How will families and residents be kept informed?**

We will share regular updates through:

- Meetings
- Newsletters
- Noticeboards within the home
- Our website [mhajersey.org](http://mhajersey.org)

# STUART COURT EXTENSION & REFURBISHMENT PROPOSAL CONT.



Not-for-profit charitable organisation .

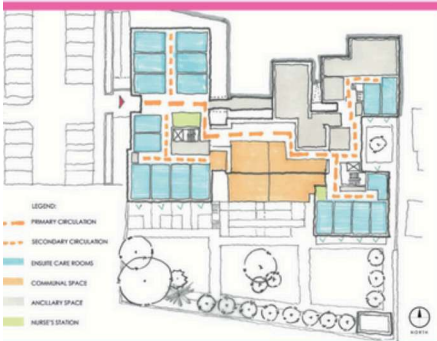

## Our Commitment to Residents and the Community

The proposed works at Stuart Court reflect our continued commitment to care, dignity, and a sense of belonging. As a not-for-profit organisation, everything we invest is focused on supporting our residents and strengthening the home they live in. By carrying out the project in carefully planned phases, starting with the new extension, we can make sure residents feel safe, comfortable, and well-supported throughout. Our aim is to create a modern, warm, and energy sufficient home, while preserving the reassuring and familiar environment that means so much to the people who live here. We will also provide our neighbours and community with regular updates on the project, share relevant contact information, and welcome them to get in touch with us regarding any matters relating to the project.

**W:** [www.mhajersey.org](http://www.mhajersey.org) | **E:** [CEO@mhajersey.org](mailto:CEO@mhajersey.org) | **T:** 01534 872454

Registered Jersey Charity No.65

February  
**10**

Tuesday

**7-9** GMT  
PM  
*sign up now*

**whole**   
**hearted**  
monthly

monthly spiritual series

online and immersive

To register for these monthly online sessions go to:

<https://www.ev-entbrite.co.uk/e/wholehearted-monthly-tickets-1082365166349>

with special guest

**Kate Raworth**

live in conversation across the globe

Hosted by  
The **Methodist** Church   
open to all



## RECYCLING – please save!

St Aubin Methodist Church collect various items that can be reused. Please drop in any you may have:

- Used stamps and old/foreign coins
- Spectacles that are no longer of use to you but can be used to improve the sight of many in third world countries.
- Greetings cards for St Aubin members who make lovely cards available in church.



# Generations

Monthly sessions that bring together old and new generations to a create a warm and welcoming environment filled with song and craft.

- Location: Ebenezer Methodist Church
- Time: From 2.45pm
- Next session on Friday the 27<sup>th</sup> of Ferbruary



Individuals and care home groups welcomed. For further information please contact Amy Britton on 07797 769186.

## Ash Wednesday Service

Georgetown

10.30am

All of Circuit welcome!



## Soup, Pud & Chat

Ebenezer Methodist Church welcomes everyone to join them at Trinity Parish Hall for their last Soup, Pud & Chat on Tuesday 24<sup>th</sup> of Ferbruary at 12.15pm to 1.30pm.

**No booking needed and no charge to attend but donations will be welcome in aid of MIND Jersey.**

If you have any questions or offers of help, please contact Rosemary on 07797 792242



---

## CIRCUIT DIARY FOR THE NEXT MONTH:

### WEEKLY EVENTS:

- Monday: Drop in at St Aubin's Methodist Church - 1pm to 4pm
- Monday: Messy Bears - 9am to 12pm (Term-time only)
- Wednesday: Coffee Buzz at Samares - 10.30am
- Thursday: Community Coffee Morning at St Aubin's Methodist Church - 10am to 12.30pm
- Thursday: Community Coffee Morning at Georgetown Methodist Church - 10am to 12 noon
- Thursday: Bible study & soup lunch at St Helier Methodist Centre

### SPECIAL EVENTS:

#### February:

- 3<sup>rd</sup> - Messy Church at Philadelphie - 3.30pm to 5.30pm
- 11<sup>th</sup> - DPC Meeting - 7.30pm
- 17<sup>th</sup> - Messy Vintage at Philadelphie - 2.30pm to 4.30pm
- **18<sup>th</sup> - Ash Wednesday Service at Georgetown - 10.30am**
- 26<sup>th</sup> - Soup, Pud & Chat at Trinity Parish Hall - 12.45pm to 1.30pm
- 27<sup>th</sup> - Generations at Ebenezer - 2.45pm

#### March:

- 3<sup>rd</sup> - Messy Church at Philadelphie - 3.30pm to 5.30pm

Remember to also check out the Circuit calendar on the Circuit website for a collection of all events happening across the circuit. If you want to have an event added, just email the circuit administrator with details of the event ([circuit.office.jsy@gmail.com](mailto:circuit.office.jsy@gmail.com)).

